

PITMEC

THE PES 160 ECCENTRIC UNDERREAMING SYSTEM



CASING SIZE 194MM OD X 175MM ID DRILLING DIA. 215MM

PNEUMEC PES 160 ECCENTRIC UNDERREAMING SYSTEM

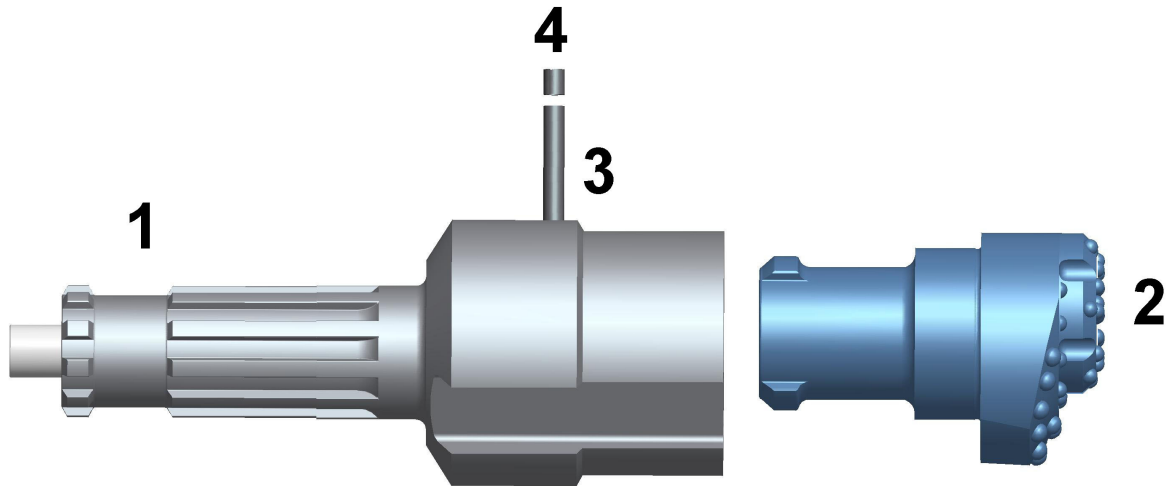

PES 160 PARTS LIST

1.	GUIDE DEVICE DHD360 SHANK	UGD160360PES
2.	ECCENTRIC BIT	UPB160PES
3.	LOCKING PIN	USP16050PES
4.	SPLIT PIN	USP16051PES
5.	COMPLETE SYSTEM	UCS160360PES

PES 160 SPECIFICATIONS

UPPER BODY DIAMETER	173MM	CLOSED DIAMETER	161M
REAMING DIAMETER	215MM	CASING SIZE	193.7MM OD X 175MM ID
SYSTEM LENGTH	690MM	SYSTEM WEIGHT	85KG

PES 160 CASING SHOES

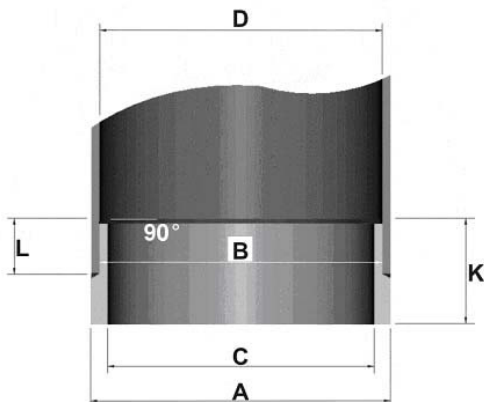

DIA. A	193.7MM
DIA. B	173MM
DIA. C	162MM
DIA. D	175MM
L	71MM
K	115MM

PNEUMEC

PNEUMEC COMPANY LIMITED

1st Floor, Tin On Sing Comm. Bldg., 41-43 Graham St. Central, H.K.

Tel : (852) 2180 9922

Fax : (852) 2180 9982

Website : www.pneumec.com

email : info@pneumec.com